

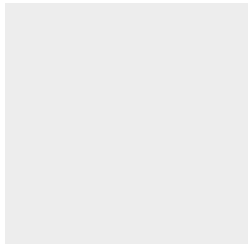



**LISO**  
ø47 1/4" h 21 5/8"







Q-TEK  
Solid Surface



5 YEARS  
GUARANTEE



Resistant to hydrolisis



High Coating resistance.



SUPERIOR HARDNES  
coating.



Anti-bacterial treatment



Consult installation  
manual.

Technical specifications are subject to change without notice. Dimensional tolerances +/- 3/16"

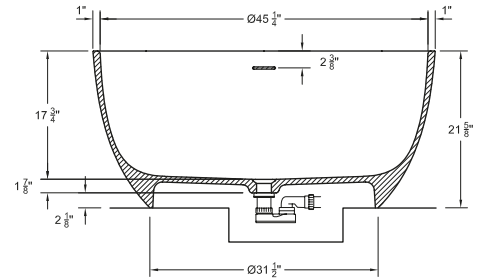
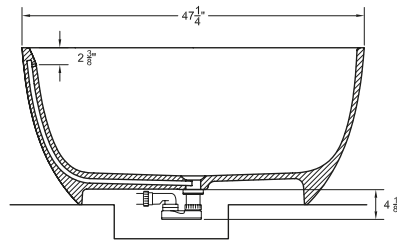

TEXTURE	LB	GAL	INCHES
LISO	190	87	ø47 1/4" h 21 5/8"

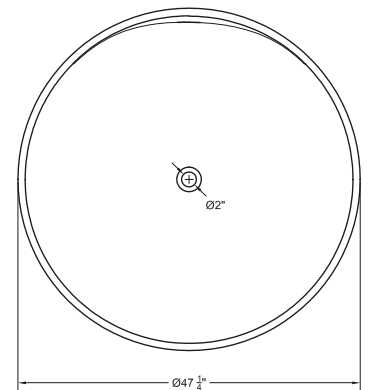

### COLOUR OPTIONS



SUPER WHITE



BI-COLOURED



SOLID COLOUR

### STANDARD COLOURS



### ACCESSORIES

DRAIN COVER MADE OF THE SAME MATERIAL AND COLOR INCLUDED

